

248-1

B7-131

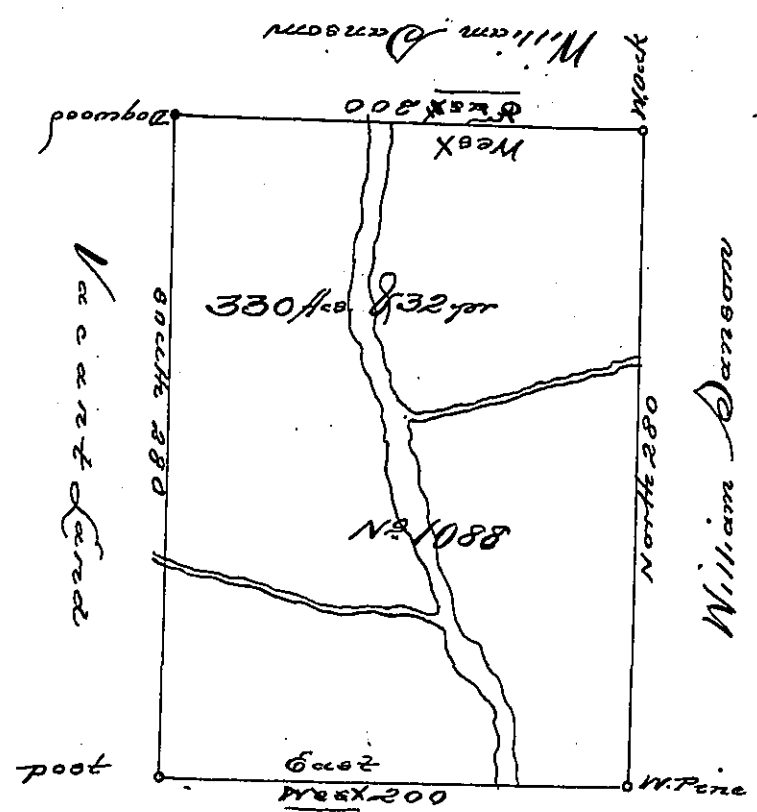

William Sansom
pg 47

In pursuance of a Warrant Nº 1088, dated 7th April 1792. Surveyed 21st September 1792 to William Sansom the above described tract of land on the main Branch of Kettle Creek, in the late purchase Northumberland County in district Nº 2. Containing three Hundred & thirty acres & allowance of six p. Cent.

J. Brodhead D.S.

Daniel Brodhead Esquire
Surveyor General

IN TESTIMONY that the above is a copy of the original remaining on file in the Department of Internal Affairs of Pennsylvania, made conformably to an Act of Assembly approved the 16th day of February, 1833, I have hereunto set my Hand and caused the Seal of said Department to be affixed at Harrisburg, this fourth day of August 1898

James W. Latta
Secretary of Internal Affairs.